

**State of Michigan
Department of Environment, Great Lakes, and Energy**

Water Resources Division
Bay City District Office
401 Ketchum Street, Suite B, Bay City, MI, 48708-5430
989-894-6200

Site Name: 32-5116 Port Austin Rd-Huron
Submission Number: HNQ-3RJW-SFEH4
Date: June 17, 2019

PUBLIC NOTICE

Barbara Werkman, 5116 Port Austin Road, Caseville, MI 48725, has applied to this office for a permit under authority of Part 325, Great Lakes Submerged Lands, of the Natural Resources and Environmental Protection Act, 1994 PA 451, as amended (NREPA). The applicant proposes to remove existing structure, install 100' of new steel seawall and toe stone along the wall's entirety. The project is located in T18N, R11E, Section 16, Lake Township, Huron County, Michigan, in accordance with plans attached to this notice.

THIS NOTICE IS NOT A PERMIT

The proposed project may also be regulated by one or more additional parts of the NREPA that are administered by the Michigan Department of Environment, Great Lakes, and Energy (EGLE), Water Resources Division (WRD). The requirements of all applicable parts are considered in determining if a permit can be issued. When a permit application is received requesting authorization to work in or over the inland waters of the State of Michigan, pursuant to Part 325 of the NREPA, the NREPA provides that EGLE submit copies for review to the department of public health; the city, village, or township and county where the project is to be located; the local soil conservation district; and any local watershed council organized under Part 311, Local River Management, of the NREPA. Additional notification is provided to certain persons as required by statute or determined by EGLE.

Those persons wanting to make comments on the proposed project shall furnish this office with their written comments no later than 20 days from the date of this notice. Written comments will be made part of the record and should reference the above application number. Objections must be factual, specific, and fully describe the reasons upon which any objection is founded. Unless a written request is filed with EGLE within the 20-day public comment period, EGLE may make a decision on the application without a public hearing. The determination as to whether a permit will be issued or a public hearing held will be based on an evaluation of all relevant factors, including the public comments received and the effect of the proposed work on the public trust or interest, including navigation, fish, wildlife, and pollution. The specific permit decision criteria can be found in the parts of the NREPA applicable to this application and listed above. Copies of these parts of the NREPA are available on the public notice Web site. Public comments received will also be considered.

The entire copy of the public notice package may be viewed at the WRD's district office listed on the top of this public notice or online at:

<https://miwaters.deq.state.mi.us/miwaters/#/external/publicnotice/search>. To access the public notice page online, search for the public notice by location or applicant name, and view by clicking on the "Documents" tab. Comments may be sent electronically by clicking on the "Add Comment" tab. A hard copy of the public notice may be requested by calling the above number.

cc:

Barbara Werkman, Applicant

Lake Township Clerk

Huron County Health Department

Huron County Clerk

Huron County Conservation District

Huron County Drain Commissioner

Huron CEA

USACE

DNR, Wildlife Division

DNR, Fisheries Division

WRD-GLSU Staff-2

Dufty's Excavating

Adjoining Property Owners-2

Local Postmaster

Digital EGLE/USACE Joint Permit Application Inland Lakes and Streams, Great Lakes, Wetlands, Floodplains, Dams, Environmental Areas, High Risk Erosion Areas and Critical Dune Areas

version 1.8

(Submission #: HNQ-3RJW-SFEH4, version 2)

Details

Form Alias Digital EGLE/USACE Joint Permit Application (JPA) for Inland Lakes and Streams, Great Lakes, Wetlands, Floodplains, Dams, Environmental Areas, High Risk Erosion Areas and Critical Dune Areas

Submission # HNQ-3RJW-SFEH4

Submission Reason New

Status Submitted

Fee \$500.00 (Paid)

Form Input

Instructions

To download a copy or print these instructions. Please click this link (recommended).

The EGLE/USACE "Joint Permit Application" (JPA)

READ THOROUGHLY BEFORE STARTING THE FORM

It is recommended to download a pdf of this page at www.michigan.gov/jointpermit for reference while filling out the form. Please also refer to this website for additional information regarding this form, including a glossary and other helpful resources on information required to be submitted in this form.

This is the Joint Permit Application (JPA) for construction activities where the land meets the water. This application covers permit requirements derived from state and federal rules and regulations for activities involving:

Wetlands
Floodplains
Marinas
Dams
Inland Lakes and Streams
Great Lakes Bottomlands
Critical Dunes
High Risk Erosion Areas

This application prevents duplication of state and federal forms for these activities and provides concurrent review under all pertinent state and federal laws. In the case of U.S. Army Corps of Engineers (USACE) jurisdiction, the Michigan Department of Environment, Great Lakes, and Energy will also send a copy of this Joint Permit Application to the USACE for simultaneous processing. The Michigan Department of Environment, Great Lakes, and Energy will provide coordination between state and federal agencies during the application review.

This application form is set up with the following sections to be completed by the applicant (note that it is recommended to gather all this information prior to starting this form):

Contact Information:

Applicant, Property Owner(s), Consultant(s), and any other Authorized Representative(s)

Digitally signed by:
nForm_nCore_MiWaters_Cert
HCv76TWATRPWA01.dnz-ad.state.mi.us
Date: 2019.06.11 13:24:57 -04:00
Reason: Copy Of Record
Location: State of Michigan

- when there is a consultant/representative for the applicant,
- when spoils disposal locations are not on site,
- when other permissions are necessary based on project specifics and are identified by the form.

Project Location Information:

Address, coordinates, and directions to the site, etc.

Background Information:

Existing site conditions, other related permits, existing easements/encumbrances, other related application numbers (pre-application meetings, Wetland Identification Program, etc.)

Permit Application Category and Public Notice Information:

This section asks what permit application category you believe fits your project. While this is not required to submit the application, knowing this will also help you submit the right permit application fee and avoid a correction request and processing delays.

The choices of permit application categories to select in the form are:

General Permit, \$50 fee ([Link to General Permit Categories](#))

Minor Project, \$100 fee ([Link to Minor Project Categories](#))

Public Notice Individual Permit, range from \$500-\$4,000 depending on type of activity. Additional fees may be applied for some special project requirements such as hydraulic analysis, dam projects, and critical dune or high risk erosion areas. See Fee Schedule on website for more information.

Unsure, select this and the permit reviewer will make the determination on permit type after the application is submitted based on the project details. However, some fee is required to be submitted with the application. If an additional fee is required, the Michigan Department of Environment, Great Lakes, and Energy will send a correction request that will show the remaining amount required. The application will not be considered complete without the proper fee.

Adjacent Landowner contact information for Public Notice projects is required by law. This includes any parcels touching the project parcel and parcels across the street.

Project Description:

Information on the Proposed Use and Purpose of the project (who and what the project is intended for and why is it needed). This includes a written summary of the project as well as a list of project uses and types to select from as follows:

Project Use Selections:

Private
Commercial
Public/Gov/Tribal
Federal/State funded
Non-Profit
Other

Project Type Selections:

Agriculture
Airport
Development- Condo/ Subdivision/Residential
Development-Commercial/ Industrial
Drain-County
Drain-Private
Drawdown
Lake, Drawdown
Wetland Forestry
Landfill
Marina/Mooring Facility
Marine Railway
Mining-Mineral,
Mining-Sand and Gravel
Private Residence
Restoration-Wetland
Restoration-Stream
Transportation
Septic System Surveying or Scientific Measuring Device
Utility-Electrical, Fiber optic
Utility-Oil and gas pipelines
Utility-Sewer/water line
Other

Alternatives Analysis detailing all options considered and why this is the least impactful feasible and prudent proposal. The depth of this analysis is typically commensurate with the size and purpose of the project and at minimum should include variables such as alternate locations (including other properties), configurations and sizes (layout and design), and methods (construction technologies), and other constraints (local regulations, resource issues). Discussion should also include why the “do nothing” alternative is not feasible or prudent.

Project Compensation:

Narrative of how proposed impacts will be compensated (mitigated or other minimization measures), including amount, location, and method; or why mitigation should not be required. This can be traditional mitigation and/or other techniques used to minimize overall loss of functions.

Resource and Activity Type. This section is intended to determine what additional sections of the application are generated (as seen on the left side of the screen) for further information gathering. This includes questions regarding what Resource feature is involved (e.g., wetland, stream, floodplain, pond, dam, critical dune, etc.) and if there are identified Special Activities (i.e., activities requiring a specific series of questions to be answered). Be sure to choose all that apply to your project. If your activity is not listed, choose “None of the Above” and move on to the next question. More specific activity questions will appear later based on the resource section answers.

Resource Information and Impacts Sections (Multiple Sections). These are a series of sections that will appear on the left side of the screen based on your answers to the Resource and Activity Types section. You will input further information on the existing resources to be impacted (e.g., wetland type, permanent or temporary impact, water elevation data, drainage area, etc.) and all proposed Project Activities with their Dimensions (e.g., length, width, depth, square footage). For example, when “Wetland” is selected as a resource that your project will involve, a “Wetland Project Information and Impacts” section will appear on the left side of the screen that includes questions specific to gathering information about the wetland.

For projects including Floodplains, Marinas, Dams, Critical Dunes, or High Risk Erosion Areas individual sections will appear on the left side of the screen that include different sets of specialized questions as required by those programs. These sections do not share a specific format. Help tips will guide you in filling out these sections.

For projects including wetlands, ponds, inland lakes, streams, or the Great Lakes resources, individual sections will appear on the left side of the screen that are similar in format to each other. Each of these resource sections asks initial general information and then has additional questions regarding the Types of Activities proposed for each resource. The outline for these resource activity impacts questions is Activity Type, Dimensions Table, and Special Questions.

There are four overall “Types of Activities” groups for wetlands, ponds, inland lakes, streams or the Great Lakes:

- Fill Activities
- Dredge Activities
- Structure Activities
- Other Activities

Under each of these Types of Activity questions, specific activity lists will be shown that are typical for that type (fill, dredge, structure, other) and resource (wetland, lake, stream, etc). Follow these steps to accurately fill out the Activity Type Questions:

1. Start with the Fill question and choose any activities on the list that is included in your project. If your activity is not shown, then select “None of the Above” and move to the next question.
2. When you select an activity listed under Fill, Dredge, Structure, or Other, a dimensions table will appear under that question. This table is where you enter EACH activity OF THE TYPE YOU SELECTED and associated dimensions. Be sure that all the activities you selected are also listed in the table with the dimensions. Multiple activities covering the same footprint may be combined on one line in the table (for example, riprap on slopes of driveway fill can be entered on the same impact dimensions line and does not necessarily need to be broken out).
3. Continue to answer the Activity Type questions (Fill, Dredge, Structure, Other) until all have been answered with either a specific Activity listed under that Type or “None of the Above”. If you did not find your activity in any list then select “Other, Other” and provide a description of your activity in the space that appears. Please be as descriptive as possible.

Proposed mitigation questions may appear within specific resource types sections based on your answers. Enter any proposed mitigation in the appropriate section (wetland, stream, etc.) and if no mitigation is proposed you must provide commentary with an explanation as to why it is not required. Mitigation plans according to the mitigation checklist (link) are required for a complete application. When mitigation is proposed be sure to also select mitigation in the Permit Application Type section under the second question.

In the above sections, uploads will be prompted as required by the answers to questions. These should be uploaded in these location (ex, mitigation plans should be uploaded in the mitigation section). Please do not wait to upload one large document with all plans combined at the end. Note that each individual upload is limited to 10M.

Any plans or explanatory narratives not requested in previous sections should be uploaded in this section. Construction Plans including overhead view, cross sections, and profiles showing each impact either to-scale or with dimensions are required and typically would be uploaded here. Plan labels should correspond with labels entered in the form for each activity selected. The application will not be complete without the proper site plans. If drawings are not received with all required dimensions and resources identified, then the Michigan Department of Environment, Great Lakes, and Energy will send a correction request and your application processing will be delayed. However, please limit drawings, plans, and narratives submitted to the items necessary for permit review. For example, entire bid package documents and CAD drawings are often not helpful for permit review and may cause delays from wading through extraneous information. Plans, profiles and cross sections specific to the resource impacts are the most helpful.

Review:

This section allows you to see the entire form with the answers you entered. Please review for accuracy prior to hitting the submit button. A print option is provided on this screen (print to PDF is recommended). Once the application is submitted you may not make changes to it until the application has been assigned to a staff person.

Certify & Submit:

This is the final section of the application form. The "Submit Form" button selection certifies that all information in the application is true and accurate and that you have the authority to apply for the permit as indicated. This application will become part of public record.

We recommend that you have the above information ready prior to starting this application. You will be able to save in-progress applications and come back later, but all required uploads and questions are necessary before the system will allow submittal of the application. Some sections of this application form load faster than others depending on the complexity of the questions. Thanks for your patience while you work through the application. For assistance with this form visit:
<https://www.michigan.gov/jointpermit>

[Click here for additional information on maps, drawings, and other attachment](#)

Contact Information

Applicant Information

Contact

First Name	Last Name
Barbara	Werkman

Organization Name
NONE PROVIDED

Phone Type	Number	Extension
Home	989-856-4481	

Email
NONE PROVIDED

Address
5116 Port Austin Road
Caseville, Michigan 48725

Is the Property Owner different from the Applicant?
No

Has the applicant hired an agent or cooperating agency (agency or firm assisting applicant) to complete the application process?
Yes

Upload Attachment for Authorization from Agent

[werkmanauthorization.pdf - 05/28/2019 07:51 PM](#)

Comment
NONE PROVIDED

Agent Contact

Contact

First Name **Last Name**

John Lapka

Organization Name

NONE PROVIDED

Phone Type **Number** **Extension**

Mobile 989-977-5646

Email

jlapka43@comcast.net

Address

4865 Billie-Lynn Drive

Caseville, Michigan 48725

Are there additional property owners or other contacts you would like to add to the application?

No

Project Location

DEQ Site Reference Number (Pre-Populated)

145467688128409576

Project Location

43.9813856,-83.20376090000002

5116 Port Austin Rd, Caseville, MI 48725, USA

Project Location Address

5116 Port Austin Road

Caseville, Michigan 48725

County

Huron

Is there a Property Tax ID Number(s) for the project area?

Yes

Please enter the Tax ID Number(s) for the project location

13-017-049-00

Is there Subdivision/Plat and Lot Number(s)?

Yes

Subdivision/Plat and Lot Number(s)

LOT 22 BLK 1 STROH SUB'D

Is this project within Indian Lands?

No

Local Unit of Government (LUG)

Lake Township

Directions to Project Site

From Caseville follow M-25 North to address 5116 Port Austin Road

Background Information

Has the Michigan Department of Environment, Great Lakes, and Energy (EGLE) and/or United States Army Corps of

Has the EGLE completed a Wetland Identification Program (WIP) assessment for this site?

No

Environmental Areas are coastal wetlands on the shorelines of the Great Lakes. Enter this number only if a designated Environmental Area is in the proposed project area. Environmental Areas are designated locations along the Great Lakes shoreline. If you don't know whether there is an environmental area within the project area, leave blank. Additional information on Environmental Areas can be found by clicking the following link:

[Click Here for Link](#)

Environmental Area Number (if known):

NONE PROVIDED

Has the United States Army Corps of Engineers (USACE) completed either an approved or preliminary jurisdictional determination for this site?

No

Were any regulated activities previously completed on this site under an EGLE and/or USACE permit?

No

Have any activities commenced on this project?

No

Is this an after-the-fact application?

No

Are you aware of any unresolved violations of environmental law or litigation involving the property?

No

Is there a conservation easement or other easement, deed restriction, lease, or other encumbrance upon the property?

No

Are there any other federal, interstate, state, or local agency authorizations associated with this project?

No

Permit Application Category and Public Notice Information

Indicate the type of permit being applied for.

Individual Permit for all other projects

This type of permit application requires that you include contact information for the adjacent landowners to this project. If you are only entering in a small number of bordering parcel owners contact information, please select "Enter list of recipients". If there is a rather large number of affected property owners such as a project that significantly affects lake levels, please upload a spreadsheet of the property owners. Please include names and mailing addresses.

Enter list of recipients.

This project may require public noticing. Please list the adjacent landowners to the project, along with any of the others that may apply:

Contact Type	Contact Person	Mailing Address	City	State	Zip Code
Adjacent Landowner	Clarence Schneeberger	5122 Port Austin Road	Caseville	Michigan	48725
Adjacent Landowner	Anthony Lipuma	5112 Port Austin Road	Caseville	Michigan	48725

General Permit Categories

[Link to General Permit Categories with Descriptions](#)

Minor Project Categories

[Link to Minor Permit Categories with Descriptions](#)

Floodplain Minor Project Categories

See R323 1316 in the linked document for a description of the minor project categories for Floodplain projects

Project Description

Project Use: (select all that apply - Private, Commercial, Public/Government/Tribal, Receiving Federal/State Transportation Funds, Non-profit, or Other)

Private

Project Type (select all that apply):

Private Residence

Please enter your answers in the text box for the next four questions. If you have a long description, please use the document upload at the end of the section. Please make every effort to enter your information directly into the application text boxes. If the answer is in an attachment, please identify that in the text box below.

Project Summary: Provide a summary of all proposed activities including the intended use and reason for the proposed project.

Remove existing failed seawall, install 100 lf of new seawall, backfill with 66.66 cyds clean commercial sand

Project construction sequence, methods, and equipment: Describe how the proposed project timing, methods, and equipment will minimize disturbance from the project construction, including but not limited to soil erosion and sedimentation control measures.

Excavate to remove existing failed seawall, drive new seawall with mechanical hammer, install tie backs, backfill

Project Alternatives: Describe all options considered as alternatives to the proposed project, and describe how impacts to state and federal regulated waters will be avoided and minimized. This may include other locations, materials, etc.

None, procedure is typical for area

Project Compensation: Describe how the proposed impacts to state and federal regulated waters will be compensated, OR explain why compensatory mitigation should not be required for the proposed impacts. Include amount, location, and method of compensation (i.e., bank, on-site, preservation, etc.)

Procedure is low impact and compensatory mitigation not required

Upload any additional information as needed to provide information applicable to your project regarding project purpose sequence, methods, alternatives, or compensation.

NONE PROVIDED

Comment

NONE PROVIDED

Resource and Activity Type

Important! Answer all questions completely. Properly identifying your project in this section generates the proper application sections. Incomplete applications will require corrections before they can be fully processed.

SELECT THE ACTIVITIES from the list below that are proposed in your project (check ALL that apply). If you don't see your project type listed, select "Other Project Type". These activities listed require additional information to be gathered later in the application.

Shore Protection such as Seawalls, RipRap, and Bioengineering

The Proposed Project will involve the following resources (check ALL that apply).

Great Lake

Major Project Fee Calculation Questions

Is filling of 10,000 cubic yards or more proposed (cumulatively) within wetlands, streams, lakes, or Great Lakes?

No

Is dredging of 10,000 cubic yards (cumulatively) or more proposed within streams, lakes, or Great Lakes? (wetlands not included)

No

Is a subdivision, condominium, or new golf course proposed?

No

Great Lake Project Information (1 of 1)

Please Read

This section is for entering information regarding the impacts to a Great Lake only. Do not input information that pertains to other resources (inland lakes, streams, floodplains, etc.).

Great Lake Water elevation reference* (show elevation on plans with description):

Other: on site measurement

Please Describe

distance from top of neighboring seawall to water table

Enter the recent observed Great Lake water elevation at the project location. This information can be found on the USACE website link below or a relative elevation can be converted from a reference point or benchmark.

[Click here for link](#)

Great Lakes observed water elevation (feet)

581

Great Lake Average water depth at activity location in a normal year: (feet)

578

Date of observation (M/D/Y)

5/28/2019

Great Lakes Information Upload

NONE PROVIDED

Comment

NONE PROVIDED

Describe any measures used to retain sediment:

none

Will a turbidity curtain be used during the proposed project?

No

If there are multiple Great Lakes associated with the project impacts, or different Ordinary High Water Mark (OHWM) elevation data on the stream reach, provide the information in duplicate Great Lakes project information tabs by clicking on DUPLICATE or ADD NEW below. This adds a new section where you will enter the information about additional project impacts.

Inland Lakes, Great Lakes and Stream Impacts (1 of 1)

PLEASE READ

This section will collect information regarding Inland Lakes, Great Lakes, and Streams impacts and activities only. The initial questions are related to which waterbody the impacts pertain to. When there are multiple waterbodies (e.g., some impacts are on an inland lake and some impacts are on a stream), fill out a DUPLICATE tab for each waterbody impacted. For each waterbody, questions will be asked regarding the proposed activities. Proposed Activities questions are grouped into Fill, Dredge, Structures, Other and are only for the impacts related to these groups. Click [HERE](#) for more information on the Inland Lakes and Streams Protection Program.

[Link to information on Inland Lakes and Streams Permitting](#)

The following impact description applies to: (select only one at a time, duplicate this entire section if there are impacts to multiple waterbody types):

Great Lake

Acres of Inland lake/Great Lake affected by your project:

Category	Acres
----------	-------

Category	Acres
Temporary	0
	Sum: 0

The following questions gather information on the specific Types of Activities your project includes that will impact INLAND LAKES, STREAMS, AND GREAT LAKES. There are four overall Types of Activities: Fill, Dredge, Structure, and Other. Under each of the Activity Type questions, specific activity lists will be shown. If the activity is not shown in the list given, select None of the Above and move to the next question. When you select an activity under Fill, Dredge, Structure, or Other, a table will appear under that type. Only enter the dimensions of the activity that are within INLAND LAKES, STREAMS, or GREAT LAKES. Multiple activities covering the same footprint may be combined on one line in the table. Continue to answer the Activity Type questions (Fill, Dredge, Structure, Other) until all have been answered with either a specific Activity listed under that Type or "None of the Above". If you did not find your activity in any list then select "Other, Other" and provide a description of your activity.

Select from the following list all Fill Activities (select all that apply to this waterbody impacted):

Backfill

Complete this table for projects involving Fill. Enter each activity/ location that corresponds with each activity selected in the previous question and enter the dimensions. Activities may be entered in one line of the table if they occupy the same impact footprint and cannot be broken out separately (Example: Activity - Driveway and Riprap slope). Multiple activities in different locations should be listed on different lines of the table.

Activity	Length (feet)	Width (feet)	Depth (feet)	Area (square feet)	Volume (cubic feet)	Volume (cubic yards)
backfill	100	6	3	600	1800	67
				Sum: 600	Sum: 1800	Sum: 67

Type of Fill

Sand

Source of Fill

Off-site

Is riprap proposed?

No

Activities Involving Dredging or Excavation: Select from the following list for Excavation/Dredge Activities (select all that apply to this waterbody impacted):

No Dredging/Excavation Proposed

If your project includes STRUCTURES then select all of the proposed activities in the following list. If your activity is not shown, then select "None of the Above" and move to the next question. Only enter an impacted area in one of the impact tables (do not duplicate impact entries):

Seawall New

Projects involving Structures:

Activity	Length (feet)	Width (feet)	Depth (feet)	Area (square feet)	Volume (cubic feet)	Volume (cubic yards)
seawall	100	.5	.5	50	25	1
				Sum: 50	Sum: 25	Sum: 1

If your project includes Other Activities not listed in this section, then select from the proposed activities in the following list. If your activity has not been listed in this Section, then select "Other" and enter a description of your activity. Only enter an impacted area in one of the impact tables (do not duplicate impact entries). If you selected a Fill, Excavation/Dredging, or Structure activity above in this section, but do not have an activity listed as Other, then

Does the proposed project include mitigation?

none

If there are multiple waterbodies associated with the project impacts, or different Ordinary High Water Mark (OHWM) elevation data on the waterbody, provide the information in duplicate stream project information tabs by clicking on DUPLICATE or ADD NEW below. This adds a new section where you will enter the information about additional project impacts.

Shore Protection Project such as Seawalls, RipRap, or Bioengineering

Select all that apply to your project.

Seawall - new or replacement

Is a cumulative length of seawalls, bulkheads, or revetments of 500 feet or more in length proposed?

No

Is the proposed structure going to extend 150 feet or more into a lake or stream?

No

Distance from the project to the adjacent property lines

Distance from property line to the left (feet)	Distance from property line to the right (feet)
0	0

Distance of project from an obvious fixed structure (example - 50 ft from SW corner of house)

24 ft from south west corner

Will any existing structures be removed as part of this project including walls or any other structure?

Yes

Please Describe.

existing failed seawall

SEAWALL

Is the seawall new, repair, or replacement?

Replacement of an existing structure

Is toe stone proposed along the entire wall?

No

Please Describe.

none

Does the proposed toe stone have a slope equal to or gentler than 1-foot vertical to 2-feet horizontal?

No

Please Describe.

none

Upload of Proposed Site Plans

REQUIRED Application, maps, and drawings:

*Overall Project Site Plan

*Cross-Sectional Drawings

For Part 315 Dam Safety applications attach detailed signed and sealed engineering plans for a Part 315 dam repair, dam alteration, dam abandonment, or dam removal.

[Examples site plan and cross-sectional drawings](#)

[For additional information on maps, drawings, and other attachments visit \[michigan.gov/jointpermit\]\(http://michigan.gov/jointpermit\)](#)

Required on all Site Plan uploads. Please identify that all of the following items are included on your plans that you upload with this application.

Site Plan Features	Existing and Proposed Plan Set
Scale, Compass North, and Property Lines	Yes
Fill and Excavation areas with associated amounts in cubic yards	Yes
Any rivers, lakes, or ponds and associated Ordinary High Water Mark (OHWM)	Yes
Exterior dimensions of Structures, Fill and Excavation areas associated with the proposed project	Yes
Dimensions to other Structures and Lot Lines associated with the project	Yes
Topographic Contour Lines from licensed surveyor or engineer when applicable	N/A

Upload Site Plans and Cross Section Drawings for your Proposed Project

[werkman.sp.pdf - 05/28/2019 09:09 PM](#)

[werkman.cs2.pdf - 05/28/2019 09:09 PM](#)

Comment

NONE PROVIDED

Additional Required and Supplementary Documents

[werkman.photo1.pdf - 05/28/2019 09:10 PM](#)

[werkman.photo2.pdf - 05/28/2019 09:10 PM](#)

[werkman.map.pdf - 06/11/2019 01:20 PM](#)

Comment

NONE PROVIDED

CORRECTION REQUEST (CORRECTED)

Driving Map/Directions Required

Fees

The application fee identified in this section is a calculation based on answers to the questions in this application. This calculation is an estimate of the total fee and will be reviewed by the application processor to determine if any additional fees are required for a complete application.

Individual Permit Fee:

+\$500.00

Total Fee Amount:

\$500.00

Status History

	User	Processing Status
6/11/2019 1:19:31 PM	John Lapka	Draft
6/11/2019 1:21:29 PM	John Lapka	Submitted

Audit

Event	Event Description	Event By	Event Date
Submission Locked	Submission Locked	Angela Cleary	6/3/2019 12:08 PM
Submission Unlocked	Submission Unlocked	Angela Cleary	6/3/2019 1:07 PM

Revisions

Revision	Revision Date	Revision By
Revision 1	5/28/2019 7:32 PM	John Lapka
Revision 2	6/11/2019 1:19 PM	John Lapka

Prepared by - JOHN LAPKA

DATE -

6-2-19

Vicinity Map

BARB
WORKMAN

SAGINAW BAY

5116 PL. Austin Rd



5-23-19

Site Plan

Saginaw Bay

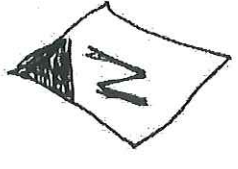

Prepared By: John Lapka

XXXX = Install New Seawall = 100 LF
Remove Existing Structure = 100 LF

100' LF

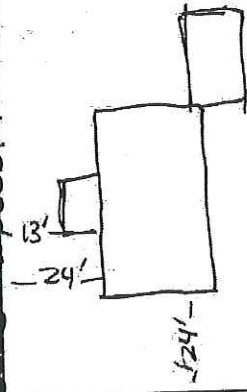

CLARENCE SCHNEEBERGER
5122 Port Austin Rd

BARBARA WICKMAN
5116 Pt. Austin Rd

ANTHONY LIPUNA
5112 Port Austin Rd

M-25

Modified by: Angie Cleary 6/14/19

Initials

Date

Property Owner:
Barbara Weckman

Property ID# 13-017049-00

Address- 5716 Ft. Austin Rd
Caseville MI 48725

446 x 3/8"

Angle Iron Cap

Back Fill Behind new seawall
6666 cu yds clean fill sand

Install 100' LF of
new steel seawall (6 gauge)

Deadwood
6' OC

1" Diameter
tie backs
6' OC

6'

7'-6"

Bottom Land

Cross Section

Prepared By:
Jawn Lapka

modified by: Angie Cleary 6/14/19

Initials Date



5-20-19

Install New
SEAWALL Along
100' Lined Ft.

Remove Failed
Structure
Along 100 FT

Address:

5116
Pine Avenue
Pine
Pine